

DIVERTER VALVES

2026

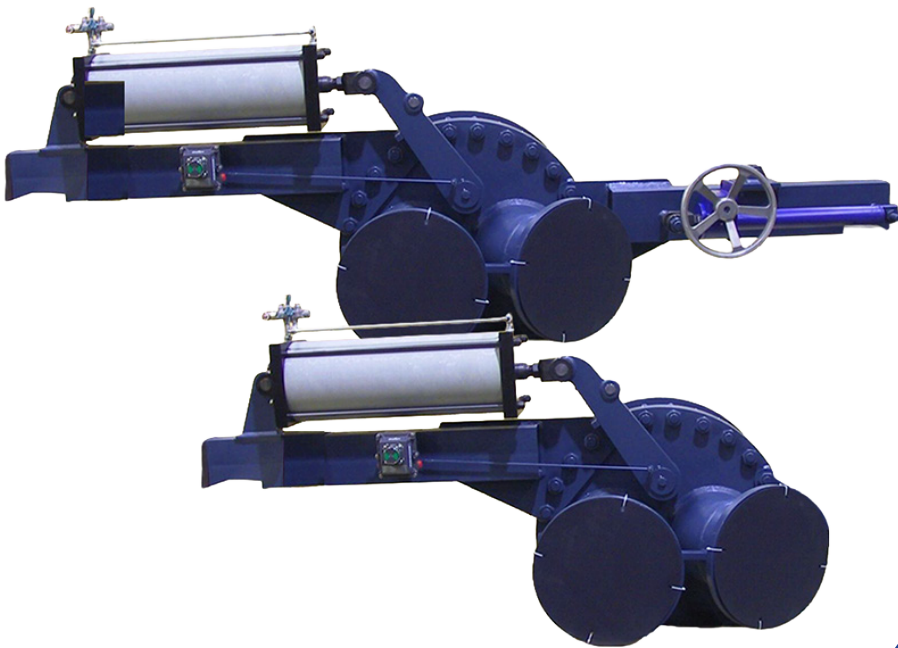

DPV SERIES

 **EVERLASTING**
VALVE COMPANY
WEARS IN, NOT OUT®

DPV Series

A complete line of Diverter valves engineered for use in abrasive and severe-service applications. A lateral “Y” connection, the assembly functions as a diverter valve capable of diverting, blending, or fully isolating material flow. Each valve incorporates Everlasting’s proven and patented rotating disc and seat design to ensure reliable sealing and long service life improving operational uptime.



Our specialty Diverter valves(DVP Series) are available in a wide ranges of sizes in standard and custom configurations to meet you application requirements. Pictured below is an application in a California Portland Cement Plant, Diverter for Cement Transfer.



DIVERTER VALVES

Diverter Valves

The Everlasting Diverter Valves can be switched on the fly, and no lubrication is required. The designs of each style are based on the open body Rotating Disc technology proven since 1906 in our two-way valves.

The disc and seats are solid hardened alloys in the 38RC to 59RC range this provides exceptionally long life in abrasive media. T

These valves have performed in titanium dioxide, fly ash, Portland cement, Alumina silica and calcified Kaolin, sugar, coal and other erosive particulate. Actuators include lever, hand-wheel, pneumatic cylinder, the valves are flanged, and pressure and temperature ranges vary with design type.



Diverter Valve Specifications

- **Sizes:** 4" (100mm) through 14" (350mm), including 5" (125mm)
- **Pressure:** ANSI Class 150 and 300 Vacuum to 100 psig (7 bar)
- **Temperature:** To 1500°F (815°C)
- **Trim:** Stellite #6, 440 Stainless Steel, Tungsten Carbide
- **Construction:** Cast Iron, Carbon Steel, Stainless Steel, Your Choice
- **Connections:** Drill Class 125 Flanged (Cast Iron), Flanged, ANSI, International Flange Standards
- **Operators:** Manual Lever or Hand-Wheel, Air Cylinder, Electric

End Connections:
Screwed, flanged, socket and butt weld designs

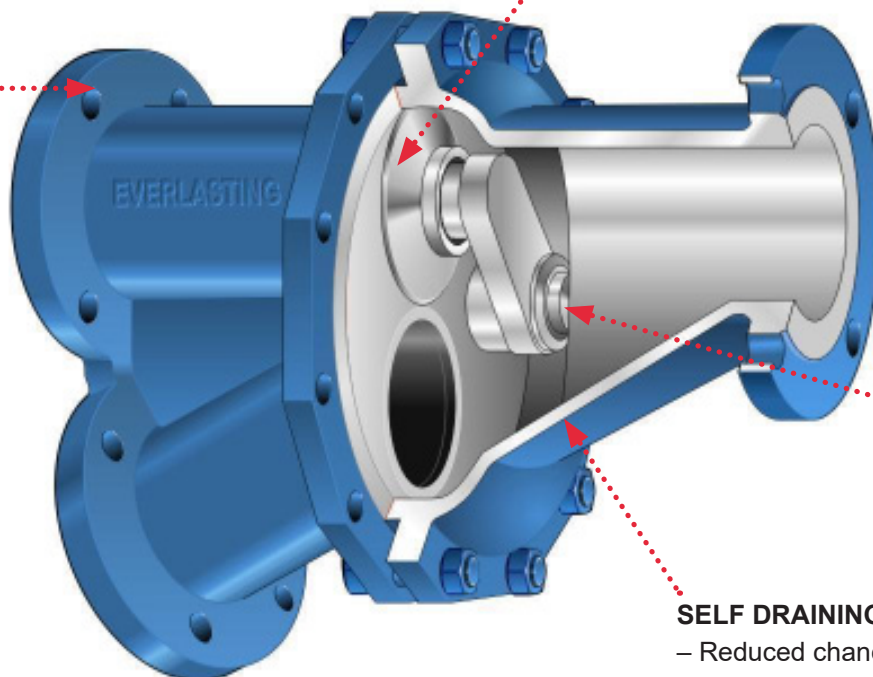

UNIQUE ROTATING/SHEARING:

DISC – Self lapping disc, enhance seat cleaning action, cuts through solids, long lasting tight shut-off

FULL PORT: –

abrasion resistance, no obstruction to flow, minimal pressure drop

ROTATING STEM:

– Increased packing life, wide selection of actuators

SELF DRAINING BODY:

– Reduced chance of jamming due to material entrainment, stagnation and degradation.

Diverter Valves

Size Range 4" (100mm) through 14" (350mm)



Switch lines on-the-fly

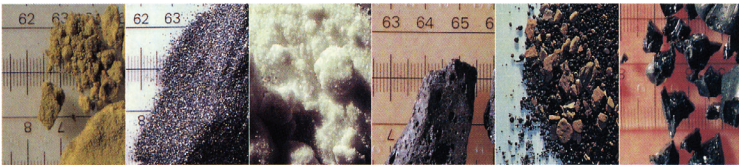

A major cement company produced 55 ton/hour, but to switch lines they had to stop the compressor then take 15 minutes to come back to pressure. Each time the lines were switched 13.75 tons of product was not conveyed. With Everlasting Diverters there is no time lost. Are your down stream lines plugging, is the fringe bin full, do you have an off quality silo? How much are you losing with your present non-switch on the fly diverters? How much are your installed diverters costing you in parts, labor and lost production?

**EVERLASTING VALVES
WILL INCREASE YOUR
PRODUCTIVITY AND
SAVINGS!**

Everlasting Diverter

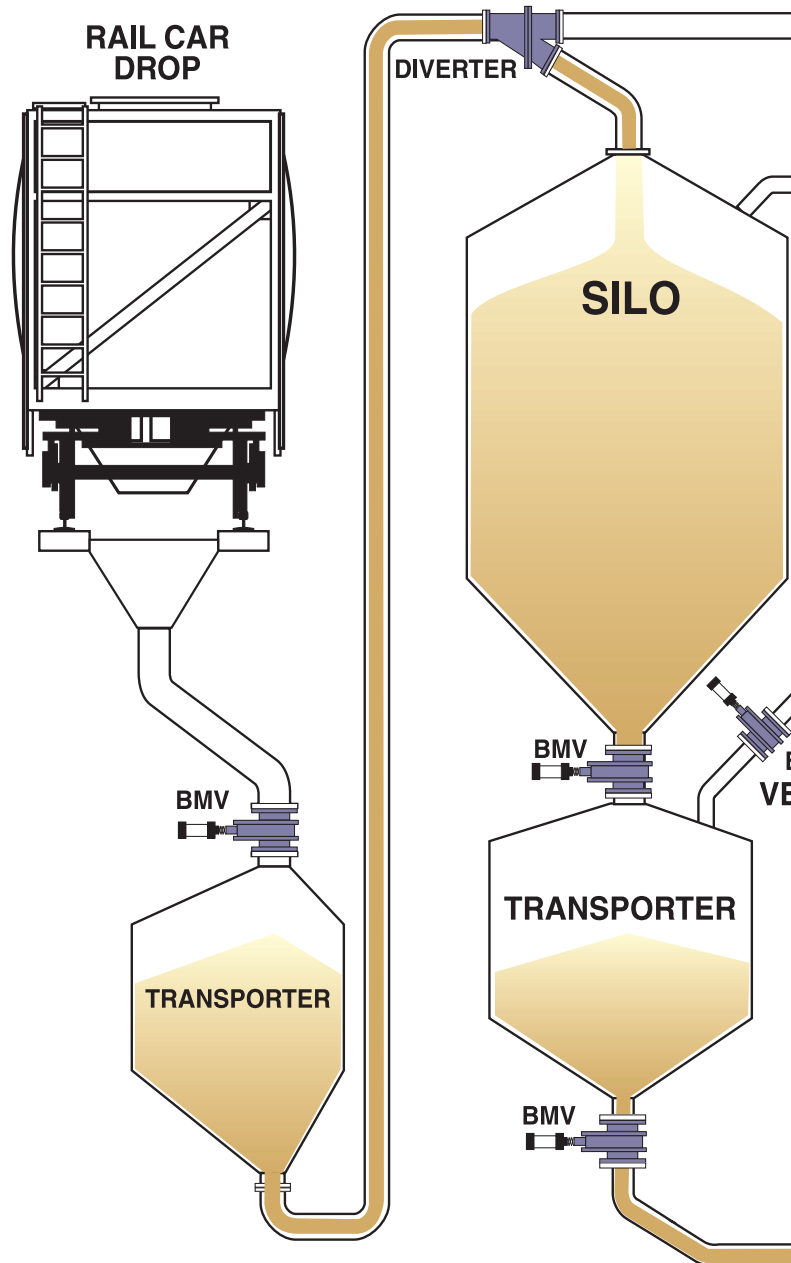



Diverter Valves

Size Range 4" (100mm) through 14" (350mm)

Diverter valves provide continuous loading

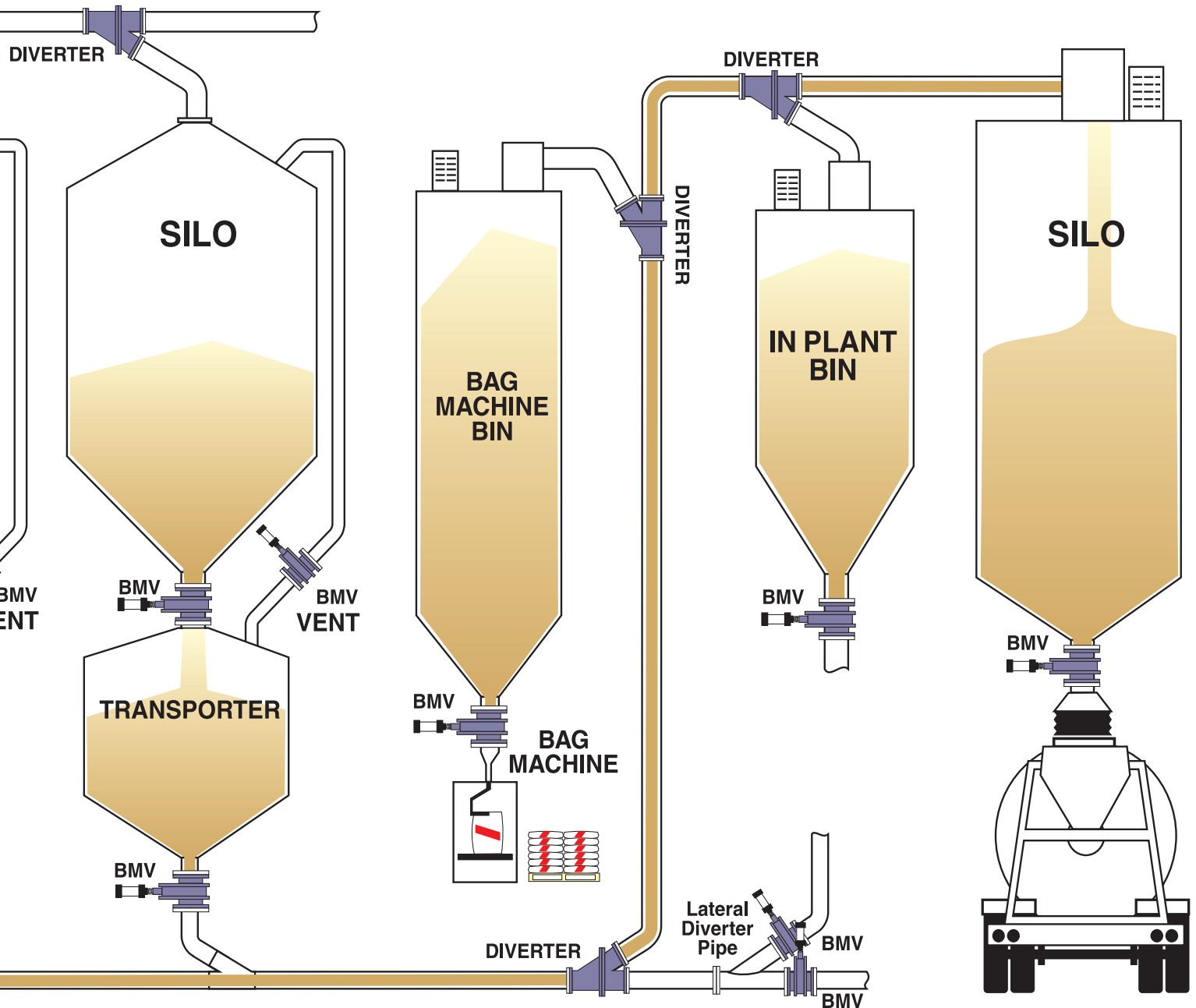

Diverter Valves

Size Range 4" (100mm) through 14" (350mm)



Technical Specifications

- Rating:** L150 & CL300 ANSI B16.34
- Temp. Range:** -20 F to 750 F
- Ends:** RF Flanged
- Body:** Carbon Steel & 316 Stainless
- Seats & Discs:** Steel Cast Stellite #6
- Configurations:** SD (Single Disc) shown at left
DD (Double Disc) bottom left
LD (Lens Disc) bottom right
- Operators:** Lever; Hand-wheel; Air Cylinder
- Accessories:** Limit Switches
Solenoid Fail Safe (Air Reservoir & Solenoid). See page XX
- Est. Cv :** 40

Notes: 1) All valves are supplied with (1) 3/8" Purge/ Drain connection. (Shown in dotted lines on drawings)

Technical Specifications:

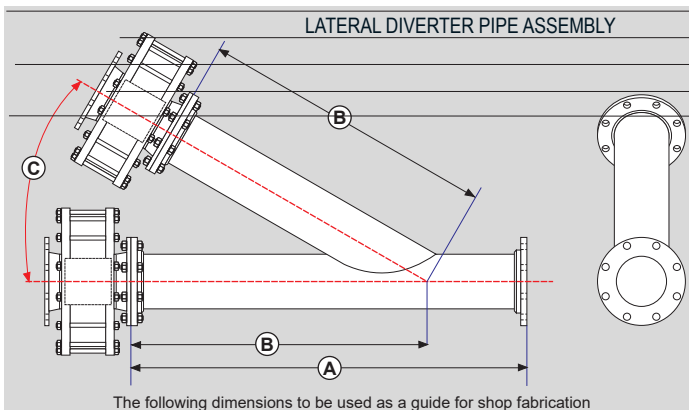

Size-inch / (mm)	(C) Angle	(A) Straight	(B) Lateral / Intersect
3"- (75)	30° 45°	30" 21"	24" 15"
4"- (100)	30° 45°	34" 24"	28" 18"
5"- (125)	30° 45°	44" 30"	32" 20"
6"- (150)	30° 45°	48" 40"	36" 24"
8"- (200)	30° 45°	60" 48"	46" 30"
10"- (250)	30° 45°	72" 54"	54" 36"
12"- (300)	30° 45°	84" 62"	66" 42"



Actuator Mounting Positions Code

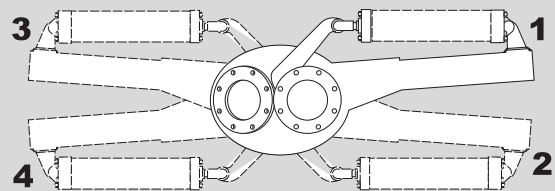

ACTUATION

Lever, manual
Wheel, manual
Pneumatic cylinder
Electric

OPTIONS

standard Solenoid valve
standard Limit switches
standard Fail Safe
optional 4-way Proximity or mechanical Air reservoir type or SR

Process Diverter standard materials of construction are carbon steel or stainless steel, other alloys are selected to suit your application. Disc and seats are solid hardened alloys in the 38RC to 59RC range for long life in abrasive media. Diverters are designed to ANSI codes and Everlasting will fabricate the valve to meet your process conditions. Various end connection configurations are available including DIN flanges. Please refer to www.evcousa.com to download a Request For Quote form (RFQ). Start saving time and money today.



Diverter Valves

Size Range 4" (100mm) through 14" (350mm)

Technical Specifications:

Cast Diverting Valve Cross-Section

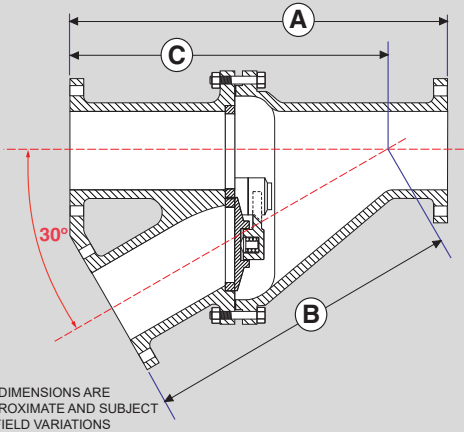

Cast Diverting Valve End View

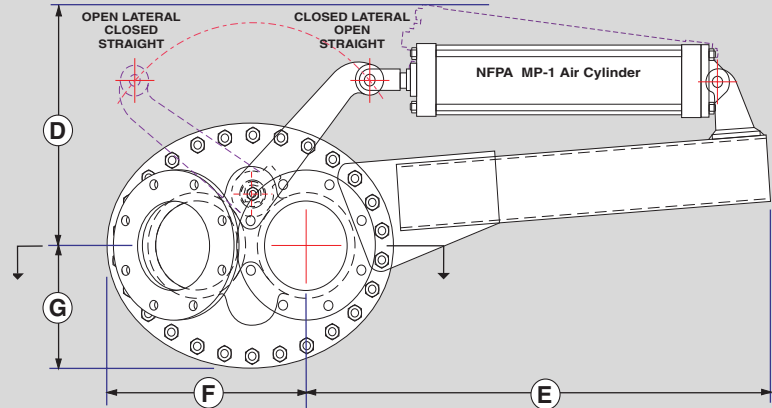

Material: Body cast Iron, class 125 flanges, disc & seats hardened alloy 38RC to 59RC

Valve (mm)	A	B	C	D	E	F	G		Press/Temp Rating
4" (100)	22"	23 1/8"	23 1/8"	16 7/8"	31 1/8"	9 5/8"	6 1/8"		100 psi / 7 bar 450° F / 232° C
5" (125)	21 3/4"	19 3/8"	19 3/8"	17 1/2"	32 1/4"	12 7/8"	7 1/2"		
6" (150)	29"	23 1/8"	23 1/8"	21 1/4"	44"	12 7/8"	7 1/2"		
8" (200)	29 1/2"	25 1/4"	25 1/4"	20 1/2"	43 7/8"	19 1/8"	10 7/8"		
10" (250)	35 1/2"	30 3/8"	30 3/8"	23 1/8"	42 7/8"	21"	11 3/8"		
12" (300)	40"	35 3/8"	35 3/8"	23 7/8"	45 1/8"	22 1/4"	11 3/8"		

Process Diverting Valve Cross-Section

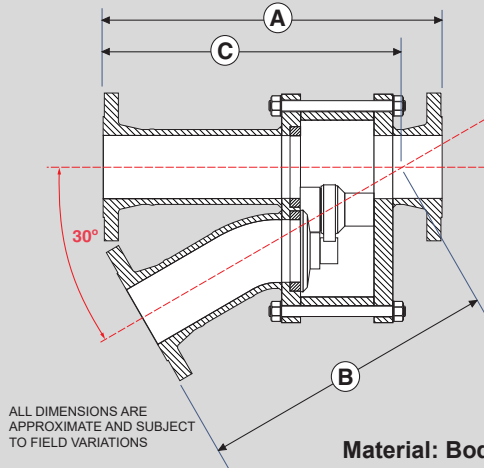

Process Diverting Valve End View

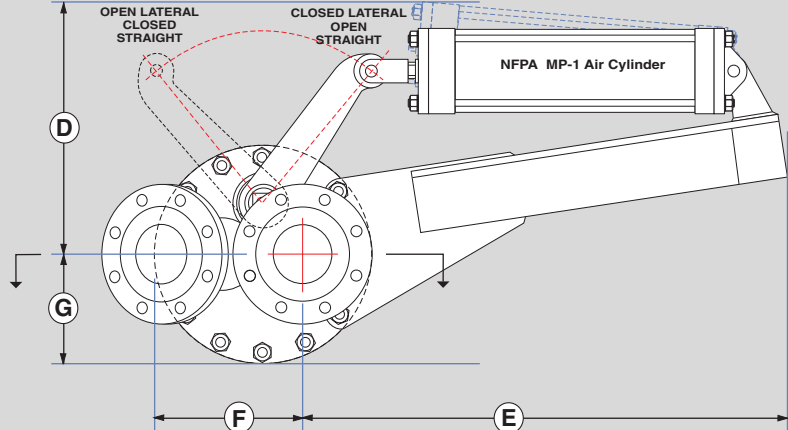

Material: Body Carbon steel / alloy ANSI, DIN flanges, disc & seats hardened alloy 38RC to 59RC

Valve (mm)	A	B	C	D	E	F	G		Press/Temp Rating
2" (50)	16 1/2"	12"	12"	10 7/8"	24 1/8"	6 3/8"	4 3/8"		ANSI B 16.34 CLASS 150.
3" (75)	19 1/2"	15 1/4"	15 1/4"	16 1/8"	33"	9 5/8"	6 1/2"		
4" (100)	21"	18 1/2"	18 3/8"	16 1/8"	31 1/2"	9 5/8"	7"		
6" (150)	22 1/2"	23"	23 1/8"	21"	44 1/4"	13 3/8"	9 5/8"		
8" (200)	26 1/2"	26 3/4"	26 1/2"	21 3/4"	41 5/8"	17"	12"		
10" (250)	30"	31 5/8"	31 1/2"	24 1/4"	47 7/8"	20 1/8"	14 1/4"		

Diverter Valves

Size Range 4" (100mm) through 14" (350mm)



Model Matrix

STEP 1: Select the configuration to build your Diverter Valve.

The functionality of the Diverter Valve can be determined by the model matrix below. Utilize the guide below to select the best valve configuration for the application.

How to configure DPV: Figure number example: **DPV-4.00-SS-DC-HW-N-N-N-N-GP-TU**.

Diverter Valve, four inch, High Stainless Steel construction, Hand-wheel, solenoid valve, General Purpose, SS Compression Fittings and Tubing.

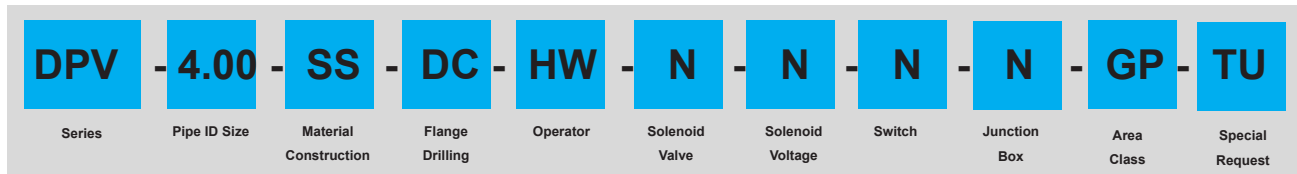

Type	Option	Description
Series	DPV	Director Valves
Pipe ID Sizes	4.00	= 4" Diameter
	5.00	= 5" Diameter
	6.00	= 6" Diameter
	8.00	= 8" Diameter
	10.00	= 10" Diameter
	12.00	= 12" Diameter
	14.00	= 14" Diameter
Material	SS	= Stainless Steel
	C	= Carbon Steel (Std)
	A	= Cast Iron
	X	= Other
Flange Drilling	DC	= Drill Class 125 Flanged (Cast Iron), Flanged, ANSI, International Flange Standards
Operator	ML	= Manual Lever
	HW	= Hand-wheel
	SE	= Single Ended Air Cylinder
	ST	= Single Ended Tandem Air Cylinder
Valve Connection	FL	= Flanged
	LG	= Lugged

Type	Option	Description
Solenoid Valve	SA	= EV Standard ASCO Solenoid
	SV	= EV standard solenoid
	N	= None
	SZ	= Other
Voltage	110	= 110V AC
	24	= 24V DC
	NS	= No SOV
Switches	EX	= EXAR Switches
	GO	= GO Switches
	N	= None
	EP	= EP Switches
	RE	= Reed Switches
Junction Box	JB	= Junction Box
	N	= None
Area Class	XP	= Explosion Proof
	GP	= General Purpose
	ZZ-ii	= Anything not included in above
Special	N	= None
	TU	= SS Compression fittings & Tubing



Diverter Valves

Size Range 4" (100mm) through 14" (350mm)

Option Identification

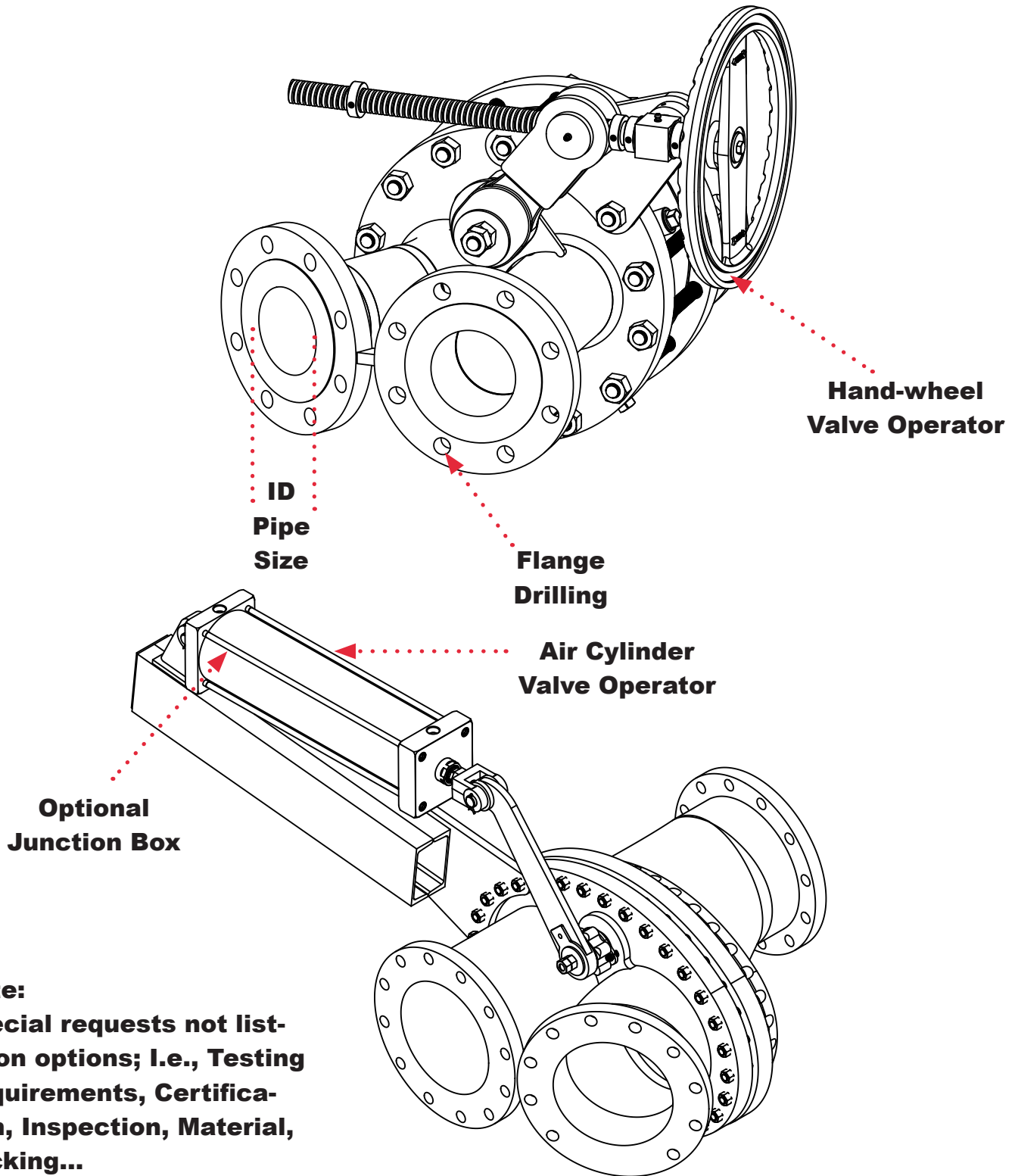

Note:
Special requests not listed on options; i.e., Testing Requirements, Certification, Inspection, Material, Packing...



Service Excellence in Action

When you choose Everlasting Valve Company, you're not just selecting a product—you're gaining a partner dedicated to long-term performance and support. Our commitment to service extends far beyond standard maintenance or repair. It means timely access to our knowledgeable team of engineers and service professionals—ready to respond anytime, anywhere your operations demand.

At Everlasting, we pride ourselves on becoming an extension of your team. You can count on us to take ownership of every challenge and deliver practical, lasting solutions. When issues arise, our technical experts go beyond the symptoms to uncover the true cause. We evaluate your complete system to identify and resolve problems with precision and care.

Our comprehensive service approach is designed to maximize equipment reliability, enhance operational efficiency, and reduce total cost of ownership.

Contact us today for your next project!



Whether you are requesting a quote, need more information, or want to discuss customized valves that address your specific requirements, just let us know. Everlasting Valve is committed to providing prompt, responsive service, every time.

Everlasting Valve Company

108 Somogyi Court
South Plainfield, New Jersey 07080

☎ 908.364.9865

📠 908.769.8697

✉ info@evcousa.com

🌐 www.evcousa.com

Distributed by: