

REPAIR INSTRUCTIONS

DISC (NO. 8W): The disc has a precision lapped face. It must be mated to a reconditioned seat face that has been ground and lapped. If grinding is not available, a smooth machine cut concentric with the port, can be taken. Tool marks must be lapped out. If a lapping machine is available, the seat face could possibly be restored by lapping ONLY.

LEVER ARM (NO. 7W): The lever arm is designed with an easy sliding fit over the head-end of the post, about 1/64" all around – a perfectly free fit.

INLET BONNET: The gasket face should be cleaned up only when necessary. Max. finish 0.020" is allowable without machining back face.

LUBRICATION: Use Never-Seez® Regular Grade on seat faces, "V"-rings, and post.

"V"-RING SET (NO. 5W): Rotate by hand when assembling to post to avoid damage to lips. Do not force ring on post. Lips of "V"-rings must face inside of valve body.

BOLTING: Tighten body bolts lightly and evenly all around before final tightening.

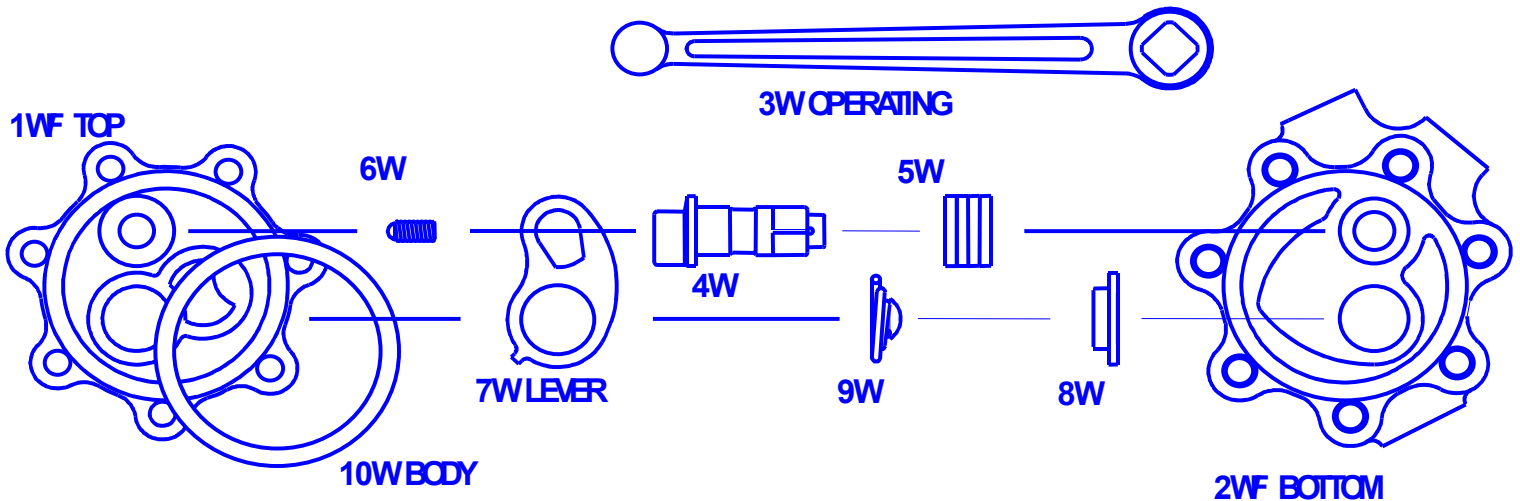

PART NAME	PART NO.
Top Bonnet Threaded, Iron	1W
Top Bonnet Flanged, Iron	1WF
Bottom Bonnet Threaded, Iron	2W
Bottom Bonnet Flanged, Iron	2WF
Operating Wrench, Steel	3W
Post, Forged Bronze	4W.....
Post Packing Set	5W

PART NAME	PART NO.
Post Spring & Rivet	6W
Lever Arm, Ductile Iron	7W
Disc for Iron Valve, Iron	8W
Disc for Steel Valve, 440-C SS	8W
Disc Spring & Rivet	9W
Body Gasket, Corrugated Stainless	10W



everlastingvalveusa.com WEARS IN, NOT OUT®



108 SOMOGYI COURT
SOUTH PLAINFIELD, NJ 07080 USA
PH: 908-769-0700 / FAX: 908-769-8697
ISO 9001 CERTIFIED